

1964

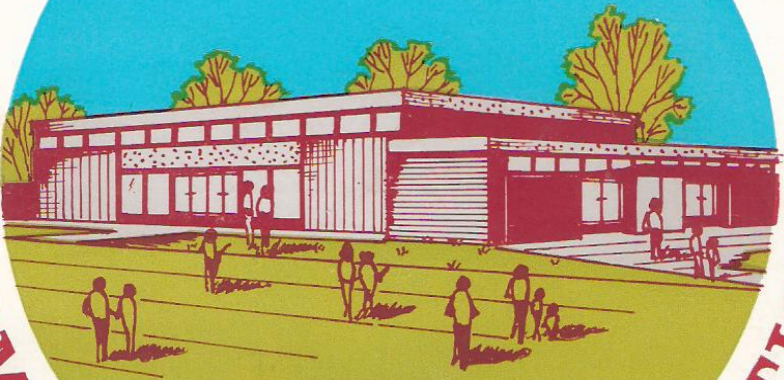

HAGLEY



COMMUNITY

ASSOCIATION



**Why not  
Lunch or Dine  
at**

**THE  
LYTTELTON ARMS  
HAGLEY**

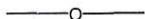

**An Ansell's House**

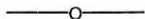

**PRIVATE LUNCHEONS, DINNERS, WEDDING RECEPTIONS  
AND DINNER DANCES A SPECIALITY**

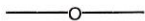

Your Host is **BILL DAY, M.C.**

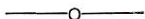

Telephone: Hagley 2213 or 2214

# It's VIVA for Value

Value every way—full, four adult roominess—  
unique even-keel suspension—tip-toe pressure  
brakes—acceleration, 50 in 13.3 seconds—  
huge boot—easiest possible parking—  
minimum servicing—maximum m.p.g.

**£527 inc. P.T.**

De luxe £566 with heater etc.

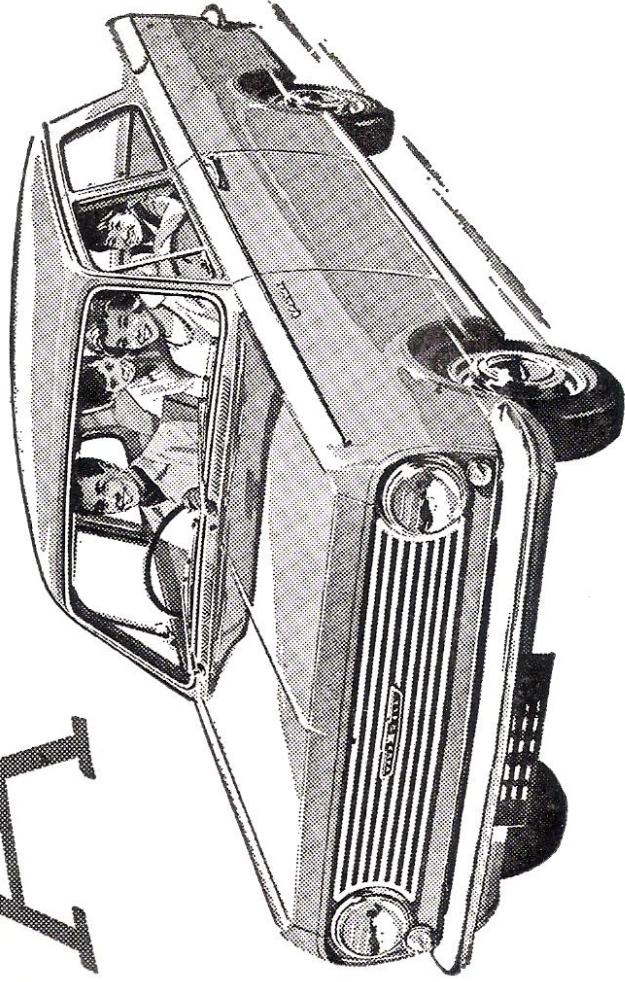

**North Worcestershire  
Garages Ltd.**

**HAGLEY ROAD, STOURBRIDGE**

Telephone 3031/5

**YOUR VAUXHALL DEALER ▶**

*Marie Lewis*

HAIRSTYLIST AND BEAUTY  
CULTURE

TOP TO TOE GROOMING



Slim the Modern Way with  
Steam Cabinet — Relaxation  
Couch and Vibrator Belt . . .

**144 HAGLEY ROAD**  
**OLDSWINFORD**  
Telephone: Stourbridge 5269

## **GEORGE GARDNER (Tailors) LTD.**

DIRECTORS: J. B. GARDNER, L. GARDNER, G. C. GARDNER

GENTLEMEN'S TAILORS AND OUTFITTERS

**119 HIGH STREET, STOURBRIDGE, WORCS.**

We hold fine stock of the following:—

Simpson and Chester Barrie Ready-to-wear Suits — Nicholson, Daks, and Dhobi Overcoats and Raincoats in various styles — Daks and Pytchley Slacks in large variety — Lincoln Bennett and Stetson Hats and Caps — Shirts by Chard, Le-Roi, Van Heusen and Rochester — Underwear by Jaegar, Morley, Wolsey and Y-Front — Gloves by Dent's and Fownes. Pure Silk Ties by Hardy Amies — We are Agents for Moss Bros. Hire Service

Telephone: 5094



BY APPOINTMENT  
TO HER MAJESTY THE QUEEN  
SUPPLIERS OF HAM

# MARSH & BAXTER LTD.



FAMOUS YORK HAMS, BACON,  
SAUSAGE, PIES & COOKED MEETS.  
**PORK AND GENERAL BUTCHERS**



---

LOCAL BRANCHES:

BRIERLEY HILL    ::    STOURBRIDGE

KINVER

Telephone: HAGLEY 2270

# THE END SHOP

(J. WOODHOUSE)

159 WORCESTER ROAD, WEST HAGLEY

---

HIGH CLASS GROCERIES  
FRUIT AND VEGETABLES

---

— ORDERS TAKEN AND DELIVERED —

**FROM " SIZE 10 TO LARGE OUTSIZE " FASHION WEAR  
BUDGET TO EXCLUSIVE PRICE RANGE**

GOWNS : COATS : SUITS : COCKTAIL : KNITWEAR : SEPARATES

## **KAY WILKINSON** " FASHION HOUSE "

157 WORCESTER ROAD  
WEST HAGLEY, WORCS.

Telephone: Hagley 2220

FOUNDATION GARMENTS — SWIMWEAR  
HOSIERY — Kaysor Bondor, Gossard, Twilfit, Avro, Excelsior, etc.  
BABY LINEN — Glamour Girl, Tudor Rose, etc.  
LINGERIE

AGENT FOR . . . Shubette : Barbara Gowns : Norman Linton : Linda Leigh  
Donbros : Warwick : Hertise : Metro Leisure Wear : Alice Edwards

Phone: HAGLEY 2740

# HAROLD NEWMAN

FAMILY GROCER AND PROVISION MERCHANT

8, BIRMINGHAM ROAD, HAGLEY, WORCS.

—ORDERS DELIVERED DAILY—

Danish and English Butter and  
Bacon

Selection of  
English and Continental Cheese

— AND ALL THAT IS BEST IN QUALITY FOODS —

# SMITH'S GARAGE

WORCESTER ROAD, WEST HAGLEY, Nr. STOURBRIDGE

Telephone: 3154 (Day or Night)

Repairs and Overhauls

Lucas and S.U. Spares

Tyres

Batteries

Breakdown Service

High Pressure Grease

Service Bay

Vehicle Testing

**R.A.C. "Get You Home" Service**

"If you are in trouble let us help you."

SPECIFY—

**BP**

FOR QUALITY

# **PRESSINGS FABRICATIONS BOLTS & NUTS**

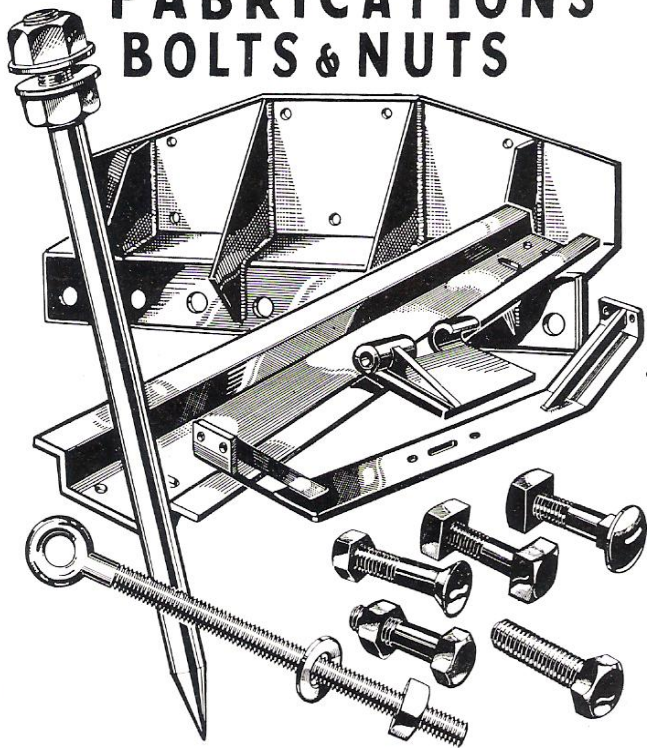

*Manufactured by*

**B. PRIEST & SONS LTD · OLD HILL · STAFFS ·**

PHONES: CRADLEY HEATH 66501/8





*We've changed to*

**M & B**

**It's Marvellous Beer  
SO SMOOTH SO FRESH**

**MITCHELLS & BUTLERS LTD · CAPE HILL BREWERY · BIRMINGHAM**

**STOUR VALLEY MOTOR CO. LTD.**

AUSTIN AND VANDEN  
PLAS DISTRIBUTORS  
RILEY DEALERS  
USED VEHICLES  
B.M.C. SERVICE

**HAGLEY ROAD, STOURBRIDGE**

Tel. 3022 (6 lines)

Telephone: HAGLEY 2447

# BEAUMONT

HIGH-CLASS

— LADIES' HAIRDRESSING —

80 WORCESTER ROAD  
WEST HAGLEY  
Nr. Stourbridge, Worcestershire

Telephone Hagley 2188

*J. H. Miller Wychbury Studio*

49, STOURBRIDGE ROAD, HAGLEY.

Child Studies and Portraiture  
Commercial and Industrial Photography  
Wedding Photography



FOR PROPERTY REPAIRS : PAINTING : DECORATING  
PLUMBING AND SIGNWRITING

Consult . . .

## E. F. COLE

7, KIDDERMINSTER ROAD,  
WEST HAGLEY

Phone: Hagley 2167

Estimates Free

Telephone: KINVER 2212 (3 lines)

# **DUNSLEY MOTORS (KINVER) LTD.**

**YOUR LOCAL VAUXHALL DEALER**

**KINVER,  
STAFFS.**

If you want to SELL a house  
in Hagley and Surrounding District . . .

If you want to BUY a house  
in Hagley and Surrounding District . . .

**COME AND SEE**

## **JOHN FELLOWS OF HAGLEY**

**ESTATE AGENTS & VALUERS**

**111 WORCESTER RD., AND 24 WESTERN RD., HAGLEY**

**Telephone No. HAGLEY 2849**

**Contact at any time**

**HAGLEY'S FIRST AND FOREMOST  
ESTATE AGENTS**

where your requirements will receive personal and prompt  
attention.

Large waiting list of clientele looking for properties of all  
descriptions in this area.

Consult . . .

## C. G. HARDWICK & SONS

(Former Head Gardener and Groundsman)

SPORTS GROUND AND  
LANDSCAPE  
CONSTRUCTION  
TARMAC DRIVES  
BEST QUALITY TURF  
ALL GARDEN REQUISITES

**THE SLADD, WOLVERLEY, KIDDERMINSTER**

Telephone: WOLVERLEY 447

Telephone: HAGLEY 2737

## WYCHBURY CAKE SHOP

GROCERIES AND CONFECTIONERY

**76 WORCESTER ROAD, WEST HAGLEY, WORCS.**

AGENTS for A. D. WIMBUSH LTD. AND KUNZLE

***Economy***  
**IS THE WORD**

***Dry cleaning***  
**IS THE WAY!**



**KEEP SMART  
WITHOUT BUYING  
NEW CLOTHES  
BY SENDING US  
REGULAR ORDERS  
for  
DRY CLEANING  
& FINE PRESSING**

Send them to **THE VALETING SERVICE AND CAREFUL CLEANERS LTD.**  
Cradley Heath 66861-2-3-4.

"There's a Branch near to you."

TO-NIGHT  
& EVERYNIGHT DRINK

**Banks's**

**ALES**

**YOUR NEAREST HOUSE:-**

**THE SPENCERS ARMS AND  
THE STATION, HAGLEY**

**BREWED AT PARK BREWERY WOLVERHAMPTON**

**F. W. LONG**

**14 MILL STREET, KIDDERMINSTER**

PHONE: 2519

Your sound specialists for . . .

**RECORDS**

—AND RECORD TOKENS  
—LARGEST STOCK IN TOWN

**RADIOGRAMS**

STEREO AND MONO BY  
DECCA, PHILIPS AND FERGUSON

**HI-FI EQUIPMENT**

LEAK, QUAD, GARRARD, DECCA  
LOWTHER

**TAPE RECORDERS**

STEREO AND MONO  
FROM 24 GNS. TO 110 GNS.

Demonstrations Daily

# P.V.C. and Fibreglas Corrugated Sheeting

## Clear Translucent Coloured



by  
RILITE  
RUBEROID AND  
ROSS

#### Applications:

Roof lighting  
Wall lighting  
Canopies  
Partitions  
Vehicle roofs  
Balcony fronts  
Shelters  
Loggias  
Shower screens  
Fascias  
Car ports  
Illuminated signs  
Protective screens  
Awnings  
Covered ways

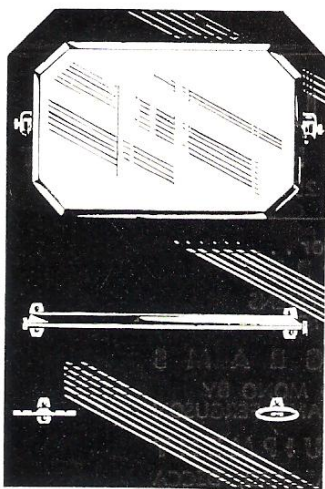

#### Manufacturers and Suppliers of:

CUSTOM BUILT MIRRORS

DOUBLE GLAZED UNITS (Purpose made  
and "Do-It-Yourself" Types)

SPLASHBACKS — SHELVES

SLIDING DOORS

SHOP FITTINGS

ADVERTISING ITEMS

GLASS COMPONENTS FOR  
ALL TRADES

# PREMIER Glass Co. Ltd

COX'S LANE, OLD HILL, STAFFS.

Tel. Cradley Heath 69397

# Foreword

**By Viscount Cobham, K.G., J.P., T.D., D.L.**

A wise man once said, "There are two kinds of fool. One says this is old therefore it must be good; the other this is new, therefore it must be better".

Every age, of course, contains an element of both; the old way, called tradition, the new, sometimes mistakenly, progress.

There is, however, one institution of great antiquity which we are in danger of losing and that is the community. With the growth of new towns and the ceaseless flow of new populations, community life is not easy to achieve, since a corporate spirit is only gained through long acquaintanceship and friendship.

Of all the ills of civilisation loneliness is one of the worst. It is also often unnecessary, and not infrequently means that the lonely person feels unable to make the first step.

The new proposed Community Centre in Hagley is a splendid project and one which should enjoy the wholehearted support of those who believe that even in this machine age the individual is all-important and is at his best when in company with others of like tastes and interests.

I hope that all Hagley people will do their best to support this far-sighted project.

COBHAM.

# Officers and Committees of the Association

Patron: VISCOUNT COBHAM, K.G., J.P., T.D., D.L.

President:	W. E. C. STUART
Chairman:	A. H. CHATTIN
Vice-Chairman:	W. NICHOLLS
Treasurer:	J. L. HAKNEY
Secretary:	T. J. EDWARDS
Publicity Officer:	A. D. B. BATHAM
Hon. Solicitor:	G. JONES
Hon. Auditor:	J. D. JASPER

## EXECUTIVE COMMITTEE

A. H. Chattin (Chairman),  
W. Nicholls, J. L. Hakney, T. J. Edwards, A. D. B. Batham,  
G. E. Rew, G. Jones, Dr. N. Turner.

## FINANCE COMMITTEE

Dr. N. Turner (Chairman),  
J. L. Hakney, A. H. Hipkins, F. Coe, G. E. Rew, H. M. Madeley,  
Mrs. D. Cole, Dr. B. Hansell.

## SOCIAL COMMITTEE

W. Nicholls (Chairman),  
Mrs. A. Akerman, Mrs. D. Batham, Mrs. A. Hakney,  
Mrs. J. Brookes, Mrs. D. Cole, Mrs. J. M. Chattin, Mrs. W. Wharton,  
Mrs. D. Maltby, H. M. Madeley, W. Hughes, Mrs. L. Jones.

## MEMBERSHIP COMMITTEE

A. D. B. Batham (Chairman),  
Mrs. D. Asher, Mrs. M. L. Harrison R. F. Willie, W. J. Potter,  
G. E. Rew.



# **A Message**

**from F. J. Symonds, the Chairman of the National  
Federation of Community Associations**

I am very grateful for the invitation to contribute to this brochure and for the opportunity it gives me of conveying to the Hagley Community Association the very best wishes of the National Federation.

Having been closely associated with the beginnings of the Association at Hagley and having attended its early meetings I have been impressed with the vision, vigour and enthusiasm of the small band of pioneers who were responsible for the birth of the idea and who have worked so hard to get it launched.

I do hope that everyone in Hagley will rally round in support. A Community Centre provides not only a focal point of community interest but a home for a varied programme of activities catering for all ages and all tastes and will meet a very real need in a rapidly growing district like Hagley. If it is to fulfil its true purpose it is vitally important that it should win the support and maintain the interest of as many of the inhabitants as possible, either as individual residents or through the organisations to which many of them belong.

Since the first Community Association was formed some 30 years ago the movement has grown steadily until there are now well over 1,000 up and down the country. They are all tailored to suit their own particular districts but each and every one of them is helping to bring people together in the service of the community, providing a corporate voice and working in many ways to make their neighbourhoods a happier and more satisfying place in which to live.

It is because I know how much a Community Centre could mean to Hagley that I urge you to give it your whole-hearted support and wish the venture every success.

# Growth of the Association

By A. H. Chattin

Late in 1961 a group of four people, moved by the enthusiasm of one of their number, met and discussed the possibility of establishing a Community Association in Hagley.

This would not be just another organisation, but a means whereby representatives of the Local Authorities and of all the groups and Societies in the district could join together with individuals in a common effort to improve the amenities of the village, to work together to provide in a Community Centre a meeting place with facilities for all sorts of worth-while functions, the centre itself would be a focal point for neighbourhood activities and services.

To assess the feeling of the people of the village a door to door approach was organised and resulted in more than a thousand signatures in support, well above 90 per cent of the persons visited.

A public meeting held in May of 1962 called for a small committee to be set up to obtain all the necessary information regarding the establishing of a Community Centre in Hagley.

During the next nine months this steering committee as it was known, met almost every week, numerous visits were made to other Community Associations in the area, facts, figures and all relevant information was carefully compiled and a proposed Constitution was drawn up.

The Parish Council arranged a further public meeting on the 4th February, 1963 to accept the report of this committee; sketch plans of a Modular type building which could if desired, be built in three stages, were also submitted and it was estimated that this would cost about £30,000 to complete.

It was at this meeting that the Hagley Community Association was formed and the Constitution adopted.

The first Annual General Meeting was held in the following June, the Association was greatly honoured when Viscount Cobham graciously consented to be Patron and Mr. W. E. C. Stuart, Chairman of the Parish Council accepted office as President, all the remaining officers and various committees were elected.

The Community now had two main aims, the fostering of a Community Spirit, the other the task of raising funds for the building of the Centre.

In the few months since June of last year, more than £1,000 has been realised by a variety of functions and by donations received, in addition the Association has grown to more than 300 members and 26 Local Organisations are now represented on the Council. The Village News, the newspaper of the Association is now well established and will soon publish the 12th issue. A splendid start then has been made towards reaching these targets.

Recently, the Parish Council, who have been most helpful throughout, agreed to make available a piece of land in the playing fields on which the Centre will be erected; and an application for outline planning permission has been made.

Application is also being made for the Government grant, which has recently been increased to 50 per cent of the costs with a maximum of £10,000. A sustained effort by every member of the Association and its supporters could well mean that the first stage of the Centre could be commenced within the next year or so.

# History of Hagley

By Miss D. I. Fletcher

Courting the muse, through Hagley Park thou stray'st;  
The British Tempe! There along the dale,  
With woods o'er-hung, and shagg'd with mossy rocks,  
Whence on each hand the gushing waters play,  
And down the rough cascade white-dashing fall,  
Or gleam in lengthened vista through the trees,  
You silent steal; or sit beneath the shade  
Of solemn oaks, that tuft the swelling mounts  
Thrown graceful round by Nature's careless hand,  
And pensive listen to the various voice  
Of rural peace.

James Thomson: The Seasons. Lines addressed to  
Sir George Lyttelton, with which "Spring" concludes

Despite the creeping tide of brick, which is rapidly depriving Hagley of its claim to the description of "village", the charm of its setting has so far escaped irreparable damage. The typically English vista of gently undulating hills and valleys would still be recognisable by Shenstone, Thomson, Pope and others who sang the charms of "Hagley's fam'd retreat". It is for these 18th century associations that Hagley is best known, but its story begins much farther back.

Hageleia is mentioned in Domesday Book and was held by a King's thane, who held his land directly from the Anglo-Saxon ruler. After the Norman Conquest these thanes were succeeded by the King's Barons and the domain included Wassell and Harborough, the latter being for several centuries the home of the Penns.

Gazing out over the pleasant landscape from the top of Wychbury Hill, little imagination is required to picture the hill as the site of a Roman camp. The nature of the locality and the discovery of various coins, funeral urns, and human bones in the surrounding fields support the view that such a camp existed, and tradition has it that a battle took place, probably at Harborough, between the Roman legions on Wychbury Hill and the Britons on Clent Hill.

'Twas on those Downs, by Roman hosts annoy'd,  
Fought our bold fathers, rustic, unrefined!  
Freedom's plain sons, in martial cares employ'd!  
They tinged their bodies, but unmask'd their mind.

William Shenstone: Elegy XV.

A Roman road passed through part of Hagley Common and a court-roll of the manor of Clent in the time of Elizabeth I mentions a road called the Portway on the lord's waste, which must have been Clent Heath. The name "Portway" was that usually given to a Roman military highway.

Part of the manor of Hagley was formerly included in the Forest of Kinver, being annexed to it by Henry II or his immediate successor, Richard I. Magna Carta shows that these seizures should have been corrected, but this was not done until 1301, as is shown in a perambulation roll of Edward I.

At the time of Domesday Hagley was held by William Fitz Ansculph, as part of his barony of Dudley. As he died without a male heir it passed to the Paganels and Somerys, successive barons of Dudley. When Roger de Somery's lands were partitioned, towards the end of Edward II's reign, the lordship paramount of Hagley and Frankley passed to Sir John de Botetourt, who had married Joan de Somery, one of Roger's sisters. Before Botetourt purchased the manor it was held by a succession of owners who, according to the custom of the time, assumed as *their* surname "de Haggeley", from their place of residence.

After Sir John de Botetourt took possession of the manor of Hagley, he appears to have granted it to one John Peoleshale (or Pelshall) for his life. At his death it reverted to Botetourt, whose title to it was confirmed in 1350. In 1370, Botetourt, describing himself as "lord of Weolegh and Haggeley", made a grant to Philip, son of Roger atte Grove de Hagley, of "Beolawe and Bodet silver" for two shillings a year. The manor was recovered from Botetourt in 1374 by Henry de

Haggeley, together with six acres of land in Clent, called Cowbach, but thirty-seven years later Henry sold both the manor and Cowbach to Thomas Walwyn, who soon alienated it to Jane Beauchamp, Lady Bergavenny. On her death in 1445 it came, according to her arrangements, into the possession of Sir James Boteler, son and heir of the Earl of Ormond. Sir James was a stout Lancastrian and for his services to the party was created Earl of Wiltshire by Henry VI. Unfortunately for him, he was taken prisoner at the Battle of Towton Field in 1461 and was executed at Newcastle, his lands being confiscated to the crown and shared out among the Yorkists. In the same year Edward IV granted the manor to Fulk Stafford and his heirs, but as he died childless in the following year, it reverted to the crown, except for the portion held by his widow, Margaret. The rest was granted by the King to Thomas Prout, who appears in a court-roll of 1466 as Lord of this manor. Prout must have died shortly afterwards, leaving no heir, for a grant of 1474 hands over Hagley and Cradley to the Queen, Elizabeth Woodville. However, it soon changed hands again, for in 1479 both manors were made over to the Abbot and Convent of Westminster, together with various privileges, in exchange for prayers for the souls of the King and Queen after their decease.

The monks of Westminster did not enjoy their new possession long, for Thomas Butler, younger brother of the Earl of Wiltshire who gave his life for the Lancastrian cause, insinuated himself into the good graces of the King and succeeded in regaining Hagley and Cradley and other lands and manors which had belonged to his brother. History does not relate what compensation the monks received for the loss of their property; one can only hope that it was adequate. Thomas Butler was evidently determined to secure full restitution of his family's rights, for in 1485 he seized the opportunity to profit by a change of King and dynasty and obtained a number of privileges for his manors of Hagley and Cradley on payment of two shillings a year to the King. Shortly afterwards a great dispute arose among Butler, now Earl of Ormond, Sir Henry Willoughby, Sir Thomas Ferrers and John Aston concerning Ormond's right to the various manors he held under the will of his grandmother, Lady Bergavenny. These wrangles were finally settled in 1495 by an award made by the High Treasurer, Lord Dynham, Lord Daubigny and the two chief justices which confirmed the disputed manors to Ormond on payment by him to the claimants of £800. Ormond further received the title of Baron Rochford and when he died in 1515 his sole heirs were his wife Anne and his two daughters, Margaret and Anne. Margaret had provided Hagley with another link with national and European history by marrying Sir William Boleyn, of Blickling Hall, Suffolk, an ancestor of Anne Boleyn, the lively, scheming young woman who inspired in Henry VIII a passion which, though short-lived, had far-reaching consequences for our nation. The other daughter, Anne, had married Sir James St. Leger, of Annary, Devon, and her share of her father's possessions was the lordship and advowson of Hagley. In 1564 her grandson, Sir John St. Leger, sold it, together with Oldswinford, Clent and Cradley, to Sir John Lyttelton of Frankley, who died in 1591, and was succeeded in turn by his son Gilbert and his grandson John. The manor now passed from one Lyttelton to the next and has remained in possession of that family until the present day, when Hagley Hall has the distinction of being one of the few "stately homes of England" to be lived in as a home, instead of becoming a museum unwarmed by family life.

Hagley played its part in the notorious Gunpowder Plot of 1605. When the news of Guy Fawkes' discovery reached the conspirators at Dunchurch, where they had met to be near the home of Princess Elizabeth, whom they intended to seize and marry to a Spanish prince, they fled and arrived in due course at Holbeach House, just beyond Kingswinford, led there no doubt by Humphrey Lyttelton, who was one of their number and whose nephew Stephen was the owner of Holbeach. Stephen Lyttelton and Robert Winter escaped in the ensuing fight with the King's men and fled to Rowley Regis. After many adventures the fugitives came at last to Hagley Hall, where they were hidden, but an under-cook betrayed them and though they both tried to flee, Winter got no farther than the stable-yard and Lyttelton was caught at Prestwood. Both were taken to London and executed. Humphrey Lyttelton was more fortunate. When brought to trial at Worcester and condemned to execution, he saved himself, it is thought, by betraying the whereabouts of other conspirators. The cook was handsomely rewarded for his part in the drama.

That the beauty of Hagley has endured, despite the tremendous increase in building which resulted from the Industrial Revolution, is due to the preservation of the lovely park around Hagley Hall, where the natural features of the landscape have been so charmingly adapted to the Classical tastes of the 18th century. This large-scale exercise in landscape gardening we owe to Lord George Lyttelton (1709-1773), who sought distraction from his grief at the loss of his first wife in 1747 by travelling around England and studying the Classical "improvements" being made on many great estates. Designers of some standing, such as Sanderson Miller, John Pitt, James "Athenian" Stuart (who designed the Temple of Theseus, which started the fashion for Greek architecture in England), were employed to provide the artificial ruins and other embellishments which the taste of the period favoured. Reports of his labours soon spread and Hagley became one of the beauty-spots of England and every traveller in the Midlands who prided himself on his taste made a point of visiting it.

But now, nor shaggy hill, nor pathless plain,  
Forms the lone refuge of the sylvan game,  
Since Lyttelton has crown'd the sweet domain  
With softer pleasures, and with fairer fame.

William Shenstone: Elegy XXIII.

It was not long before its owner became dissatisfied with the old Jacobean Hall, so entirely at variance with the Classical adornments rising around it. As in our own time, when taste in buildings has so completely changed that many worthy, as well as worthless, and pleasing structures are being demolished solely on the grounds that they are out of date, so in the 18th century, when the austere beauty of ancient Greek and Roman architecture was regarded as representing the highest peak of perfection in that art, many charming buildings in the Tudor and Jacobean style, now considered crude and vulgar by elegant society, were swept away. Lord George appears to have consulted numerous architects, relations, and friends, who must have found his many changes of plan and interminable theorizing exasperating and hard to bear, but the design finally accepted was that of Sanderson Miller. The foundations were laid in 1754 and in September, 1760, a great party, lasting three days, was held to celebrate the formal opening of the new Hall, on which, together with the magnificent furnishings, £34,000 had been spent.

It is this building, with its austere plain lines, which dominates the charming park to-day. A fire on Christmas Eve, 1925, destroyed many treasures from among the pictures, manuscripts, books and furniture, but skilled attention made good much of the damage and the house contains much of beauty and value. Of special interest in this quatercentenary year of Shakespeare's birth is a First Folio of the great poet's works. Sculpture is represented by Rysbrack and Scheemakers; painting by such great names as Van Dyck, Sir Joshua Reynolds, Allan Ramsay and Richard Wilson. The Long Gallery has been restored by Lord Cobham and is a most elegant and lovely room.

The Lyttelton family has given many notable leaders to the nation, among them Sir Thomas Lyttelton (died 1481), a judge and author of the Treatise on Tenures, a legal work which became an indispensable part of the studies of law students and on which Sir Edward Coke (1551-1634), Chief Justice of the King's Bench, wrote an equally well-known commentary in his "Institutes of the Laws of England": Sir Edward Lyttelton, Baron Munslow (1589-1645), another eminent lawyer, who rose to be Lord Chancellor of England: Sir George Lyttelton (1709-1773), created first Baron Lyttelton in 1757, whose activity in creating the Hagley Hall and Park we know to-day has already been described and who was, in addition, secretary to Frederick, Prince of Wales, son of George II, and the author of poems and theological works: Charles Lyttelton, who became Bishop of Carlisle in 1762 and who took a keen interest in the antiquities of Hagley: William Henry Lyttelton (1724-1808), who in 1758 became Governor of Jamaica, Ambassador to Portugal in 1766 and served as Lord Treasurer under Lord North. In our own time, the present Lord Cobham, who gives ungrudging service to his own neighbourhood and county, has also represented his country as Governor-General of New Zealand.

Another notable family of Hagley was that of the Penns, of Harborough Hall. Although the name William occurs frequently in the family, there is no conclusive

evidence of a link with William Penn, the Quaker founder of Pennsylvania. The last male heir, William Penn, died in 1731, leaving three daughters as his co-heiresses. The eldest, Anne, married Thomas Shenstone, of the Leasowes, Halesowen, and became the mother of William, the poet; Mary, the second daughter, married the Rev. Thomas Dolman of Broome. Of considerable interest is an erudite treatise known as the Penn Manuscript, half of which is devoted to the arms and blazons of the nobility and gentry of Worcestershire, the other half to a disquisition on heraldry, called "The Mystery of Misteries: or, the Secrets of Heraldry discovered". The author of this remarkable work is generally assumed to be John Penn, a staunch Royalist, who took a very poor view of Cromwell and the ravages of his soldiers. A 15th century Penn, Richard, was a generous benefactor to Worcester Cathedral and to the parishes of Hagley, Clent, Pedmore, etc.

A study of the lists of the payers of the window-tax in Hagley in 1721 affords an interesting indication of the social standing of various inhabitants at the time. Sir Thomas Lyttelton paid £1 10 Od. "for his house and 30 windows", but so did Mr. Sparry, for the same number of windows, and close behind them came Mr. Palmer, the Lytteltons' steward, paying £1 for 29 windows. Mr. William Penn also paid £1 for 29 windows. Next comes the Rector, Robert Durant, and Richard Geering, who paid 6s. for 19 windows. John Tyzack had only nine and paid 2s., which seems to have been the minimum rate, for John Wyatt with four windows and Edward Guest with only three also paid 2s. The study of such records, including parish registers, to which further reference will be made later, is very rewarding to the social historian and frequently entertaining also.

The story of any ancient parish church is intimately bound up with the history of both parish and nation, for apart from its spiritual significance, much jurisdiction which is now in the hands of the local government authorities was then the charge of the parish church and its officers. The parish church of St. John the Baptist stands in Hagley Park, its slender spire rising from among the trees in pleasing contrast to the square solidity of the Hall's four towers. That there was a church here in the 11th century is attested by the entry in Domesday Book, which mentions a priest among the inhabitants of Hageleia, and a priest presupposes a church. Dr. Treadway Nash, the 18th century author of the great History of Worcestershire, is of the opinion that the church was rebuilt some time in the early 13th century, possibly by the Somerys, who held Hagley at that time. The church is mentioned in a Survey for Old Swinford of 1549, then nothing further is known until 1754, when, Nash says, extensive rebuilding and improvements were effected, largely at the expense of the enterprising George, Lord Lyttelton, but partly of Dr. Charles Lyttelton, who later became Bishop of Carlisle. An entry in the registers records these alterations. The windows given by these two benefactors unfortunately no longer exist, but a full description of them may be found in the Transactions of the Worcestershire Archaeological Society for 1938.

The next alterations were made in 1809, when the body of the church was painted and the chancel roof stripped and the interior decorated at the expense of Lord George Fulke Lyttelton. In 1827 and 1828 the church was enlarged and again in 1856 the urge to enlarge and improve the building resulted in the almost total demolition of the existing structure, with the exception of the east end of the south aisle and its three arches. The new church was re-dedicated with much pomp and ceremony on 15th April, 1858, the Bishop of Oxford, the Rt. Rev. Samuel Wilberforce, D.D., being the preacher at the morning service. A tower and spire, made of stone from a quarry in the park, were added seven years later, thanks mainly to the tireless efforts of the Rector, Canon W. H. Lyttelton, and a further ceremony on 22nd August, 1865, marked the completion of the restoration. After the death of Canon Lyttelton in 1884 a ring of eight bells was hung in the tower as a fitting memorial to him, for he had greatly desired to add bells. They were dedicated in 1885.

But the reconstructed church was not to be left in peace. In March, 1947, a violent storm blew down a beech tree, which in its fall caused extensive damage to the south aisle and west end. Fortunately there are always many who treasure their parish church and the response to the appeal for £4,000, the estimated cost of the repairs, was immediate and encouraging. The sum was raised in less than four months and by 30th May, 1948, the church was ready for the great service of thanksgiving, conducted by the Bishop of Worcester, the Rt. Rev. W. W. Cash,

D.S.O., O.B.E., D.D. The Rector who inspired and led the work of restoration was the Rev. W. C. Hodgins, brother of the present Rector, the Rev. R. J. Hodgins, who continued his brother's good work by having the roof renewed. It is pleasant for two members of a family to have thus co-operated in such a rewarding task.

Nothing could be more serene and peaceful than the typically English prospect of the pretty little church glimpsed through the great trees, facing the great pile of Hagley Hall, and it is difficult to associate such serenity with the changes and upheavals in which the church has been involved. It is blessed in having had so many loyal and generous friends and something of the loving and devoted spirit which inspired their labours lingers within its walls, for its peaceful, happy atmosphere makes it a church in which worship is the joy it should be.

Early in this century it was felt that as West Hagley was growing so rapidly provision should be made for a church for its increasing population. The Rev. Manley Power, Rector of Hagley and his curate, the Rev. E. H. Longland, were convinced of the need and in 1901 a piece of land at the four cross roads was purchased. A meeting to discuss the building of the church was not held until 1905, when it was thought that funds would not be sufficient for a stone church and plans were made for a brick one. In 1906, however, a generous benefaction under the will of Miss Hazlehurst enabled more ambitious schemes to be drawn up, and under the guidance of Mr. Wickham King, the present attractive building was planned. The materials were local; calcareous sandstone from Hasbury for the outside; the softer Pedmore sandstone for the interior and capitals of Bromsgrove sandstone. Buildings thus constructed of local materials, whenever erected, soon "belong" to their surroundings and do not, as is the case of so many modern buildings, remain eternal aliens and eyesores. The Church of St. Saviour was dedicated on 28th November, 1908, by the Bishop of Southwark. The Bishop of Worcester being unable to be present, it was felt that the Bishop of Southwark, who was brother-in-law to the Lord Cobham of the time, would, on account of his strong local associations, be a suitable person to officiate at the ceremony.

The Registers of the parish church date from 1538, the year in which Thomas Cromwell first ordered that records of births, marriages, and deaths should be kept in every parish, but they are not complete. An index to these registers, up to 1889, was made by Mr. Wickham King, former Magistrates' Clerk in Stourbridge. He presented it to the church in 1894, and on his retirement to Ottery St. Mary, Devon, in 1941 he gave it into the care of the late Mr. H. E. Palfrey, the Stourbridge local historian and antiquarian.

History is still being made in Hagley. Changes must inevitably occur, as ways of life change, but it is much to be hoped that those responsible will give careful thought to the manner in which changes are carried out, for it is a responsibility to live in a place that has for centuries been a famous beauty-spot. Enthusiasm for progress should never be the occasion of the destruction of beauty and character, denying to future generations what one has been privileged to enjoy oneself. The great new highway now in course of construction will bring many more visitors to Hagley, but if the beauty they come to see has been destroyed to provide the road, their journey will only end in disappointment. New homes must be provided, new amenities introduced to meet the needs of those who settle here, but it should be remembered that they come here because Hagley attracts them. It is a thriving, flourishing community and should take a proper pride in preserving the character of the pleasant village around which it is centred. The inhabitants of Hagley should feel, like the nymph in Shenstone's "Pastoral Ode", that they would never "descend to stray From Hagley's famed retreat".

# Building the Centre

By W. Nicholls

The Centre is to be erected on the village playing field immediately behind the library. The area of the site is approximately 2,100 square yards measuring 70 yards from the west wall of the library by 28 yards from the northern boundary of the field. Access will be from Worcester Road via the car park and the entrance drive, included in the total area of the site, is adjacent to the entrance gates to the library.

The complete building proposal occupies most of the site area available. There will, however, be a small forecourt in front of the main entrance for parking cars and for a service road to the boilerhouse, kitchen and stores.

The Centre has been planned to enable building operations to take place in phases as finance becomes available. The accommodation proposed in the immediate phase is considered to be the minimum required to ensure that all members whatever their interests, can be adequately catered for in the best possible way.

In this context, room spaces have been carefully juxtapositioned so that three or more activities can take place at the same time — yet without disturbance to each other. Each space has, in addition, direct access from the kitchen for serving of refreshments.

Some rooms are designed for dual purpose use. For example the large Committee room can be divided by sliding folding doors with each space having a separate access. The Hall, designed to accommodate nearly 250 people, can also be enlarged by using the Coffee Lounge, sliding doors being provided to separate these two spaces at other times.

The size and shape of each room in the Centre has been regulated to the dimensional disciplines of a simple building structure so that maximum value for money can be obtained. In this respect the recommendations of the European Productivity Agency and the International Standards Organisation for a modular planned building have been adopted.

Manufacturers of modular buildings not only supply the component parts but carry out the necessary foundation, drainage and site works and erect the structure complete. Guarantees on quality of materials and workmanship and compliance with British Standard Specifications and Codes of Practice for buildings are usually given.

The basic cost of the immediate building proposal will be in the region of £15,000, varying according to standard of structure, type of heating installation and specification of finishes chosen. An additional sum will be required for furnishing and special equipment and for a service road, paths and fencing.

A floor plan complete with a schedule of the accommodation provided and an impression of the Hall and Coffee Lounge is shown on the following pages.



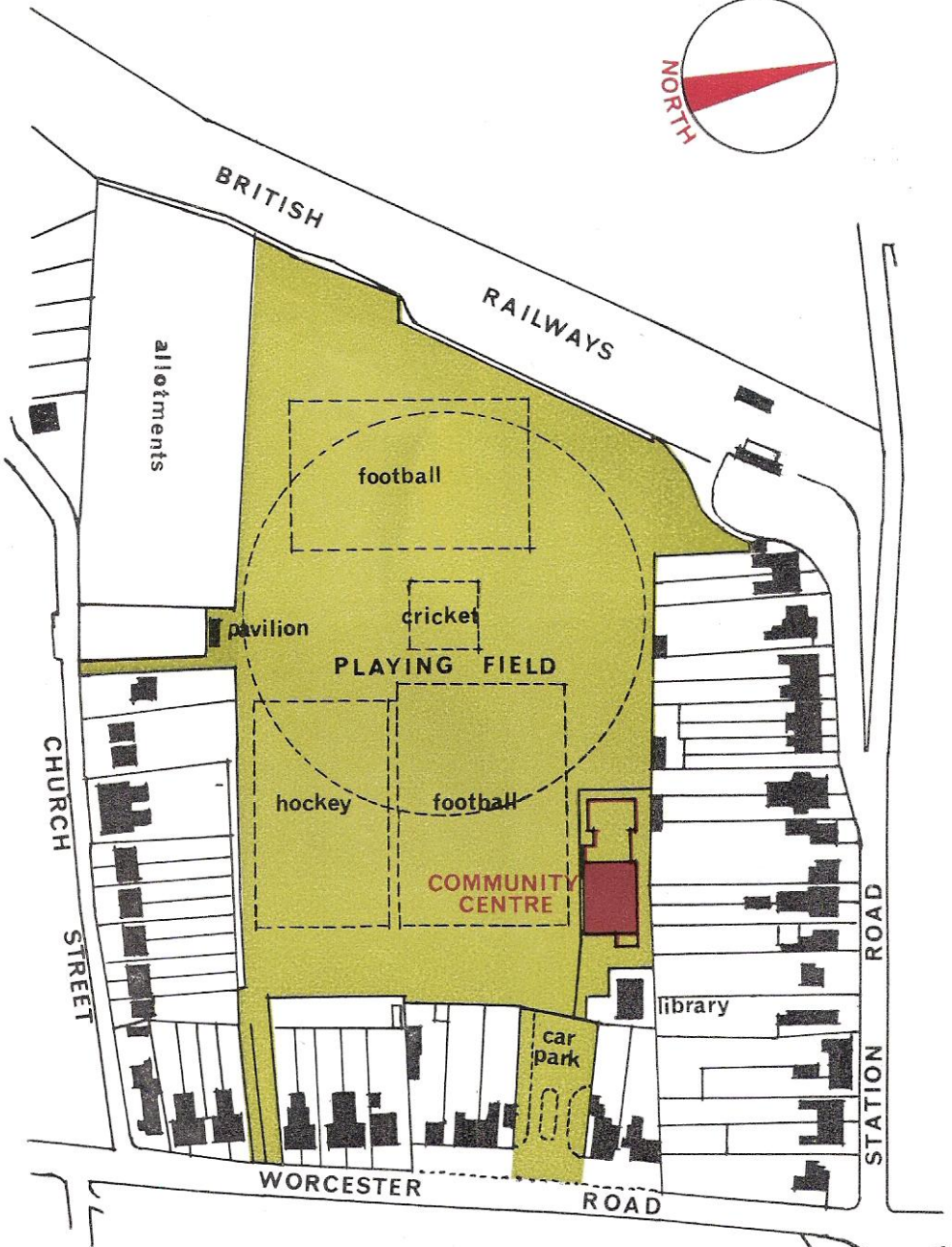

# SITE PLAN



playing field

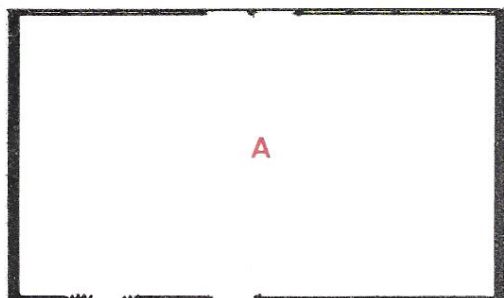

A

B

C

D

E

changing

stores

FUTURE BUILDING

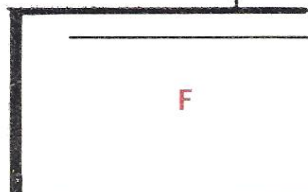

F

G

H

I

J



6

1

2

3

4

5

service

playing field

7

8

9

10

11

12

13

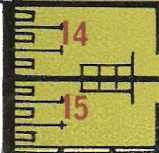

14

15

16

centre entrance

K

L

FUTURE BUILDING

PLAN

# HALL AND LOUNGE BAR

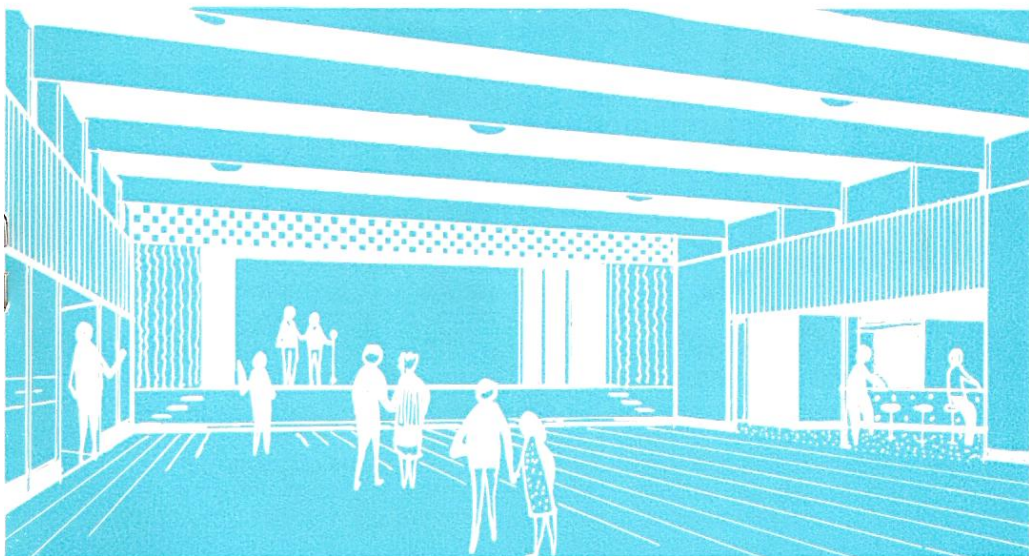

## KEY TO ACCOMMODATION

### Immediate Building

1.	Male Toilets	...	...	...	...	10' 8" x 5' 4"
2.	Female Toilets	...	...	...	...	10' 8" x 5' 4"
3.	Committee Room	...	...	...	...	21' 4" x 16' 0"
4.	Chair Store	...	...	...	...	8' 0" x 5' 4"
5.	Boiler House	...	...	...	...	8' 0" x 5' 4"
6.	Temporary Platform Stage	...	...	...	...	26' 8" x 13' 4"
7.	Hall	...	...	...	...	64' 0" x 37' 4"
8.	Coffee Lounge/Bar	...	...	...	...	21' 4" x 18' 8"
9.	Kitchen	...	...	...	...	21' 4" x 10' 8"
10.	Cleaners Closet	...	...	...	...	6' 4" x 5' 4"
11.	Clinic Staff Toilet	...	...	...	...	5' 4" x 5' 4"
12.	Darts/Waiting Room	...	...	...	...	16' 0" x 10' 8"
13.	Committee/Games/Clinic	...	...	...	...	32' 0" x 21' 4"
14.	Male Toilet/Cloaks	...	...	...	...	16' 0" x 8' 0"
15.	Female Toilet/Cloaks	...	...	...	...	16' 0" x 8' 0"
16.	Entrance Foyer	...	...	...	...	32' 0" x 16' 0"

### Future Building

A.	Gymnasium	...	...	...	...	53' 4" x 32' 0"
B.	Gymnasium Equipment Store	...	...	...	...	10' 8" x 8' 0"
C.	Outside Games Equipment Store	...	...	...	...	10' 8" x 8' 0"
D.	Male Changing Room	...	...	...	...	10' 8" x 10' 8"
E.	Female Changing Room	...	...	...	...	10' 8" x 10' 8"
F.	Stage	...	...	...	...	37' 4" x 21' 4"
G.	Property Stage	...	...	...	...	8' 0" x 5' 4"
H.	Green Room	...	...	...	...	16' 0" x 10' 8"
I.	Property Store	...	...	...	...	8' 0" x 5' 4"
J.	Green Room	...	...	...	...	16' 0" x 10' 8"
K.	Wardens Office	...	...	...	...	10' 8" x 10' 8"
L.	Craft Room	...	...	...	...	21' 4" x 16' 0"

# Hagley Community Association Building Fund

The Community Association was formed in Hagley in February, 1963. This Association has at present 350 members and includes Representatives from most local organisations, and its objects are, amongst other things, the erection of a Community Centre in the playing fields.

A community centre provides people with a meeting place and a focal point for all activities and service. The Association believe that with the growth of the population in Hagley the existing facilities are wholly inadequate and that such a centre as envisaged will be of immense value to everybody.

The Association has the support of the Parish Council which is prepared to lease a site in the Playing Fields at a nominal rent.

It is estimated that the total cost of the proposed centre will be about £30,000 although we hasten to point out this figure will not include furniture and equipment. A Grant of up to £10,000 might be obtained from the Ministry of Education towards this amount, but the majority of the money will have to be raised by the people of Hagley themselves.

From what is stated above you will observe that there is an immense task in front of us but, with a united effort it can be done.

The Association is constantly promoting money raising activities, but this of itself is not enough and so it has been decided to ask you and all the other inhabitants of this village to help us achieve our object with the utmost possible speed. Ways in which this can be done are as follows:

- (a) By becoming a Member of the Association and actively participating in all the activities being organised by them.
- (b) By making a donation.
- (c) By entering into a seven year covenant which will enable the Association to obtain the benefit of tax relief.
- (d) By supplying materials for the construction of the centre.

We trust that you will support this project which will benefit not only yourself but succeeding generations of inhabitants of this delightful village.

Should you want any further information any member of the Committee will be very pleased to call and discuss this matter with you if you will get in touch with them.

Yours very sincerely,



Chairman.



Secretary.

# List of Village Organisations

## **Bromsgrove Rural District Council**

Clerk: George F. Badham, 94 Birmingham Road, Bromsgrove.

## **Hagley Parish Council**

Clerk to the Council: Mr. R. H. Lewis. Tel. 3173.

Meetings every 3rd Monday of the Month.

## **Hagley Rambler Scouts Group**

Group Scoutmaster: T. W. Pagett, 160 Worcester Rd., West Hagley. Tel. 2302.

Headquarters: Hall Lane, Hagley.

## **British Legion) Blakedown and Hagley Branch**

Secretary: G. Pardoe, 11 Park Road, West Hagley. Tel. 2518.

Meetings held at Park Road School.

## **Historical and Field Society**

Secretary: Miss M. F. Bate, 73 Worcester Road, West Hagley. Tel. 2349.

Meetings held monthly in Park Road School at 7.45 p.m.

## **United Nations**

Secretary: Miss M. F. Bate, 73 Worcester Road, West Hagley. Tel. 2349.

Meetings held at Park Road School, May and October.

## **Hagley Parochial Church Council**

Secretary: E. N. Smith, 17 Middlefield Lane, Hagley. Tel. 2481.

## **Young Wives Group**

Secretary: Mrs. S. Pritchett, 3 Summervale Close. Tel. 2970.

Meetings 2nd Tuesday in the month at Church Hall.

## **Hagley and District Light Car Club**

Secretary: G. I. Tucker, 115 Bewdley Hill, Kidderminster. Tel. Kidd 4686.

Headquarters: Perry Hall Hotel, Bromsgrove.

Meetings every Wednesday Evening, 9 p.m.

## **Hagley Catholic Women's League**

Secretary: Miss G. Hinley, "Greensleeves", Park Road.

Meetings last Monday of the month at the Catholic School.

## **Hagley Liberal Association**

Secretary: Mrs. N. Gee, 37 Western Road, Hagley. Tel. 2796.

Meetings every 2nd Tuesday of the month.

## **West Hagley Football Club**

Secretary: Jim Holt, 7 Summervale Close, West Hagley.

Training: Tuesday and Thursday.

## **Hagley Women's Institute**

Secretary: Mrs. D. Milner, Kidderminster Road, West Hagley.

Meetings held every 3rd Monday of the month in Church Hall.

## **Worcestershire County Council**

Clerk: W. R. Scurfield, Shire Hall, Worcester.

## **Hagley Conservative Association**

Secretary: Brian Cook, "Greenbank" Station Road, West Hagley. Tel. 2176.

## **Hagley Hockey Club**

Secretary: Peter Packwood, 12 Kidderminster Rd., West Hagley. Tel. 2801.

## **Lets Do A Play Club**

Secretary: Miss P. Lewis, Dene Cottage, Wychbury Drive, Hagley. Tel. 3173.

Meetings on Mondays and Thursdays, 7.45 p.m., Park Road School.

## **Hagley Coffee Club**

Secretary: Mrs. Pat Nicholls, 48 Kidderminster Rd., West Hagley. Tel. 3630.

Meetings every alternative Wednesday in Church Hall, at 8 p.m.

## **Conservative Ladies' Section**

Secretary: Mrs. Clarke, "Hylston", 17 Park Road, West Hagley. Tel. 2820.

Meetings as arranged.

## **Hagley Infant Welfare Clinic**

Secretary: Mrs. D. Batham, 71 Worcester Road, West Hagley. Tel. 2322.

Clinic Hours: 2.0-4.0 o'clock. Every 2nd and 4th Wednesday of the month.

## **West Hagley Cricket Club**

Secretary: John Edwards, 79 Lodge Crescent, West Hagley. Tel. 2963.

## **Anglican Young People's Association**

Secretary: E. A. Jewes, 10 The Crescent, West Hagley.

Meetings every Thursday in the Church Hall, 7.30-9.30 p.m.

# Roll of Honour

---

1914/18

C. Tudor Bennett

Bernard Cookson

John Collins

William Davies

Roland Day

Arthur W. Eld

Samuel T. Eley

C. Wilmot Evans

Walter B. Fieldhouse

Walter Gough

Ronald Gough

James E. Hopcutt

William G. Hopcutt

Maurice M. Pearson

Thomas J. E. Price

Percy C. T. Pudge

L. Frank Pudge

Frederick Tate

Lionel G. O. Townsend

Francis A. Wyer

1939/45

Allen Kenneth Jackson

Basil Eric Jeffreys

Donald Ernest Lampitt

George Vincent Forbes Lloyd

Phillip Gough Norton

Frank Oliver

Dennis Graham Rock

John Benjamin Joseph Smith

Alexander Sargeant Taylor

Alfred Francis Betts

Eric Buller Bingham

Harold Victor Burns

Charles Patrick Bury

Peter James Cowgill

Austin Douglas Evans

David Hugh Gittins

Barry Laughton Goodwin

Henry Macdonald Goodwin

# Bankers' Order

To

BANK LIMITED.

Date.....19.....

Please pay the HAGLEY COMMUNITY ASSOCIATION the sum of.....

.....

the first payment to be made on the .....

and continue so to pay that amount on the.....

in every year to the debit of my/our account until .....

.....19..... inclusive or until receipt by you of further notice in writing from me/any one of the joint account holders.

£.....



Title of joint account,  
when applicable. ....

## Deed of Covenant

To THE HAGLEY COMMUNITY ASSOCIATION.

I/WE, .....

.....  
(Name and Address)

HEREBY COVENANT with THE HAGLEY COMMUNITY ASSOCIATION, that for a period of Seven years from \* .....

I/WE will pay annually to THE HAGLEY COMMUNITY ASSOCIATION such a sum as will after deduction of Income Tax at the standard rate for the time being in force leave in the hands of HAGLEY COMMUNITY ASSOCIATION the sum of.....

.....  
(amount in writing and figures)

the first annual payment being made on the .....

.....  
(date in writing)\*  
and subsequent payments to be made on the same day in each succeeding year.

Dated this ..... day of ..... 19 †

Signed  
In the presence of

Seal, if any.

\* These two dates to be the same.

† This date to be before the other two.

## HAGLEY COMMUNITY ASSOCIATION

### ESTIMATED INCOME AND EXPENDITURE ACCOUNT AS AT THE 31st MARCH, 1964

INCOME	£	EXPENDITURE	£
Donations ... ..	337	Rent of Rooms, Insurance	
Summer Raffle ... ..	103	Stationery, Postage, etc.	23
Garden Party ... ..	32		
Dances ... ..	321	Excess of Income over	
Bonfire & Barbecue	118	Expenditure Transferred	
Tote... ..	67	to Surplus Account ...	1,016
Other Events ... ..	61		
	£1,039		£1,039

### ESTIMATED BALANCE SHEET AS AT THE 31st MARCH, 1964

LIABILITIES	£	ASSETS	£
Surplus Account ...	1,016	<b>Fixed Assets at Cost</b>	
		£	
		Amplifier ... ..	25
		Cups & Saucers ...	18
		—	43
		<b>Liquid Assets</b>	
		Unused Tote Books	9
		Ash Trays ... ..	20
		Cash at Bank and	
		in hand ... ..	944
		—	973
	£1,016		£1,016

This account represents a true and accurate state of the Association's affairs and to the best of my belief and knowledge will not differ substantially from the audited account prepared at the above date.

J. L. HAKNEY, Hon. Treasurer.

11/3/64



## CONSTITUTION of the HAGLEY COMMUNITY ASSOCIATION

### 1. NAME

The name of the Association shall be Hagley Community Association (hereinafter called "the Association").

### 2. OBJECTS

The objects of the Association shall be:

(a) To promote the benefit of the inhabitants of the Parish of Hagley in the County of Worcestershire (hereinafter called "the area of benefit") without distinction of sex or of political, religious, or other opinions by associating the local authorities, voluntary organisations and inhabitants in a common effort to advance education and to provide facilities in the interests of social welfare for recreation and leisure-time occupation with the object of improving the conditions of life for the said inhabitants.

(b) To establish or to secure the establishment of a Community Centre (hereinafter called "the Centre") and to maintain and manage, or to co-operate with any local statutory authority or authorities in the maintenance and management of such a Centre for activities promoted by the Association and its constituent bodies in furtherance of the above objects.

The Association as such shall be non-party in politics and non-sectarian in religion.

The Association shall have power to affiliate to other organisations such as the National Federation of Community Association.

### 3. MEMBERSHIP

Membership of the Association shall be of two kinds:

(a) Individual members who shall be either Full, Junior or Associate members.

(b) Group members who shall be Constituent bodies and Sections.

### 4. INDIVIDUAL MEMBERSHIP

Individual membership shall be open, irrespective of political party, nationality, religious opinion, race or colour, to:

(a) All persons aged eighteen and over living in the area of benefit who shall be called full members.

(b) All persons under the age of eighteen living in the area of benefit who shall be called Junior members. Junior members shall not have the right to vote at members' meetings but may elect from among themselves two representatives to the Council who shall each have the right to vote as if they were Full members.

(c) Well-wishers anywhere who shall be called Associate members. Associate members shall not have the right to vote at members' meetings but may elect from among themselves one representative to the Council who shall have the right to vote as if he were a Full member.

The manner in which Associate and Junior members elect their representatives shall be determined by the Council from time to time.

### 5. GROUP MEMBERSHIP

(a) Constituent bodies shall be the local statutory authorities and such voluntary organisations as operate in the area of benefit and satisfy the Council that they are independent organisations or branches of independent national or other organisations.

(b) Sections shall be such groups as may, with the permission of the Council, be formed within the Association among the individual members for the furtherance of a common activity.

Each Constituent Body and Section shall have the right to appoint two representatives to be members of the Council and at any time by giving notice in writing to the Secretary of the Association to revoke the appointment of such members and to appoint other members in their place and such members shall have the right to attend and vote at General Meetings of the Association.

### 6. TERMINATION OF MEMBERSHIP

The Council shall have the right for good and sufficient reason to terminate the membership of an individual member or of a Constituent body or Section provided that the individual member or person representing the body or Section shall have the right to be heard by the Council before a decision is made.

7. **SUBSCRIPTIONS**

All members and Constituent bodies shall pay such subscriptions as the Council may from time to time determine.

8. **THE COUNCIL**

Subject to the limitations set out in Clause 10 hereof, the policy and general management of the affairs of the Association shall be directed by a Council (herein referred to as "the Council") which shall meet not less than three times a year.

The Council shall consist of:

- (a) The representatives appointed by Constituent bodies and Sections in accordance with Clause 5.
- (b) Such number of representatives of Full members, to be elected from among and by themselves at the Annual General Meeting, as is equal to 2 per cent of the number of Full members.
- (c) Two representatives of Junior members elected in accordance with Clause 4 (b).
- (d) One representative of Associate members elected in accordance with Clause 4 (c).
- (e) One representative of Worcestershire County Council.
- (f) Two representatives of Bromsgrove Rural District Council.
- (g) Four representatives of Hagley Parish Council.
- (h) The Honorary Officers of the Association and of the Council ex-officio in accordance with Clause 9 (a).
- (i) Such persons employed by or seconded to the Association as the Council may from time to time determine in accordance with Clause 9 (b).

In addition the Council may co-opt further members who shall be members of the Association provided that the number of co-opted members shall not exceed one-third of the total number of members of the Council as defined above. All members of the Council shall retire annually but shall be eligible to be appointed or co-opted again. The Council shall have power to appoint such committees as it may from time to time decide and may determine their powers and terms of reference.

9. **OFFICERS**

- (a) **Honorary Officers.** The Annual General Meeting shall elect a President, a Chairman, a Vice-Chairman, a Treasurer and such other officers of the Association such as an Honorary Secretary as it may from time to time determine.

All honorary officers of the Association shall be ex-officio members of the Executive and all other committees.

- (b) **Paid Officers.** The Council shall have power to appoint and dismiss a (paid) Secretary and such other employees of the Association as it may from time to time determine.

The Council may determine which (if any) persons employed by or seconded to the Association, shall be members ex-officio of the Association, the Council, the Executive and other committees.

10. **ANNUAL GENERAL MEETING**

Once in each year, in the month of June the Council shall convene an Annual General Meeting of the Association, which all individual members and representatives of Constituent bodies and Sections shall be entitled to attend, for the purpose of receiving the Annual Report of the Council and the annual audited statement of Accounts; of appointing Honorary Officers of the Association; of accepting resignations of members of the Council; of electing representatives of Full members to serve on the Council; of appointing an auditor or auditors; of making recommendations to the Council and, whenever necessary, of voting on proposals to amend this Constitution in accordance with Clause 18 hereof.

11. **SPECIAL GENERAL MEETINGS**

The Chairman or the Secretary may at any time at their discretion, and shall within twenty-one days of receiving a written request so to do signed by not less than twenty members having the power to vote and giving reasons for the request, call a Special General Meeting of the Association for the purpose of altering the Constitution in accordance with Clause 18 hereof or of considering any matter which may be referred to them by the Council or for any other purpose.

12. **EXECUTIVE COMMITTEE**

The Council shall have power to appoint an Executive Committee and such

- sub-committees as it may from time to time decide and may determine their powers and terms of reference.
13. **RULES OF PROCEDURE AT ALL MEETINGS**
- (a) **Voting.** Subject to the provisions of Clause 18, all questions arising at any meeting shall be decided by a simple majority of those present and entitled to vote thereat. No member shall exercise more than one vote notwithstanding that he may have been appointed to represent two or more interests but in case of an equality of votes the Chairman shall have a second or casting vote.
- (b) **Quorum.** One-third of the members shall form a quorum at meetings of the Council, the Executive and all other committees. Twenty-five members shall form a quorum at General Meetings of the Association.
- (c) **Minutes.** Minute books shall be kept by the Association, the Council, the Executive, and all other committees and the appropriate Secretary shall enter therein a record of all proceedings and resolutions.
14. **STANDING ORDER, AND RULES FOR USE OF THE CENTRE**
- The Council shall have power to adopt and issue Standing Orders, and/or Rules for the use of the centre. Such Standing Orders and Rules shall come into operation immediately, provided always that they shall not be inconsistent with the provisions of this Constitution.
15. **FINANCE**
- (a) All moneys raised by or on behalf of the Association shall be applied to further the objects of the Association and for no other purpose.
- (b) The Honorary Treasurer shall keep proper accounts of the finances of the Association.
- (c) The accounts shall be audited at least once a year by a properly qualified auditor or auditors who shall be appointed at the Annual General Meeting.
- (d) An audited statement of accounts for the last financial year shall be submitted by the Council to the Annual General Meeting.
16. **TRUST PROPERTY**
- The title of all and any real property which may be acquired by or for the purposes of the Association shall be vested in the Official Trustee of Charity Lands who shall enter into a Deed of Trust setting forth the purposes and conditions under which he holds the said property in trust for the Association.
17. **DISSOLUTION**
- If the Council by a simple majority decides at any time that on the ground of expense or otherwise it is necessary or advisable to dissolve the Association it shall call a meeting of all individual members and representatives of Constituent Bodies and Sections of the Association who have the power to vote and of the inhabitants of the area of benefit of the age of eighteen years and upwards of which meeting not less than 21 days notice (stating the terms of the resolution to be proposed thereat) shall be posted in a conspicuous place or places in the area of benefit and advertised in a newspaper circulating in the area of benefit and given in writing to the Minister of Education and the Secretary of the National Federation of Community Association. If such decision shall be confirmed by a simple majority of those present and voting at such meeting the Council shall have power to apply any assets remaining after the satisfaction of any proper debts and liabilities towards such charitable purposes for the benefit of the inhabitants of the area of benefit as the Council may decide and as may be approved by the Minister of Education.
18. **ALTERATIONS TO THE CONSTITUTION**
- Any proposal to alter this Constitution must be delivered in writing to the Secretary of the Association not less than 28 days before the date of the meeting at which it is first to be considered.
- An alteration will require the approval of both:
- (a) a simple majority of members of the Council present and voting at Council meeting;
- (b) a two-thirds majority of individual members and representatives of Constituent Bodies and Sections of the Association present and voting at a General Meeting.
- Notice of each such meeting must have been given in accordance with normal procedure but not less than 14 days prior to the meeting in question and giving the proposed alteration.
- No alteration of Clause 2 shall be made without the consent of the Minister of Education.

# Donations

	£	s.	d.
Anonymous ... ..	100	0	0
"          ... ..	50	0	0
Womens Institute ... ..	65	0	0
Dr. Maxwell Turner ... ..	25	0	0
Mr. J. Horton ... ..	25	0	0
Mr. A. H. Chattin ... ..	25	0	0
Lets Do A Play Club ... ..	17	2	0
Anonymous ... ..	10	0	0
Mr. B. Smith ... ..	5	5	0
Mrs. D. I. Batham ... ..	1	1	0
Midland News Ltd. ... ..	2	2	0
Mrs. J. F. Remington ... ..	3	6	6
Anonymous ... ..	2	15	0
Mrs. Raisin ... ..	5	10	0
	£337 1 6		

*The Officers and Committee  
of the Association wish to  
extend their grateful thanks  
to the advertisers whose generous  
support has greatly assisted in  
the publication of this brochure.*

*All readers are requested to  
give the advertisers their  
patronage.*

**HARPER**

**BUILDING CONTRACTORS**  
**CIVIL ENGINEERING CONTRACTORS**  
**PAINTING & DECORATING CONTRACTORS**  
**JOINERY MANUFACTURERS**  
**DEPARTMENT FOR SMALL CONTRACTS**

**FREE ADVICE AND COMPLETE SCHEMES**  
**FOR ALL TYPES OF BUILDINGS**

**J. HARPER & SONS (BLACKHEATH) LTD.**  
**BLACKHEATH, BIRMINGHAM**

**Telephone: BLAckheath 2011/5**

## **FOSTER & WISE LTD.**

IRONMONGERS & HARDWARE DEALERS

All types . . .

MOTOR MOWERS  
HAND MOWERS

MERRYTILLER  
GARDEN CULTIVATORS

GARDEN TOOLS  
ETC.

CUTLERY AND KITCHEN  
APPLIANCES

IRONMONGERY FOR  
ALL HOUSEHOLD USES

ELECTRIC DRILLS

PERMOGLAZE AND  
DULUX PAINTS

**10 - 12, BULL RING  
KIDDERMINSTER**

Tel.: 2175, 2047

VISIT OUR WALK ROUND SHOWROOMS

## **BESIDES PRINTING . . .**

From our showrooms in

**CHURCH STREET, HALESOWEN**

We can supply —

TYPEWRITERS  
ADDING MACHINES  
ACCOUNTING MACHINES  
OFFICE FURNITURE  
FILING CABINETS  
and all OFFICE REQUIREMENTS

**UNITED COUNTIES PRINTERS LIMITED  
FORGE LANE, HALESOWEN**

Telephone: HALESOWEN 2065/6/7

# **GUY PITT & CO. LTD.**

**COAL AND COKE MERCHANTS**

**All types of fuels available**

**Prompt deliveries in all areas**

STATION WHARF,  
HAGLEY

Telephone: Hagley 2453

PENSNETT TRADING ESTATE,  
BRIERLEY HILL

Telephone: Kingswinford 3107/8

**A Member of the Lunt, Comley & Pitt Group**

## **Stourbridge Model Laundry Ltd.**

**HAGLEY ROAD, OLDSWINFORD**

THREE DAY SERVICE IN MOST  
DISTRICTS FOR  
LAUNDRY AND DRY CLEANING  
Dry Cleaning Returned on Hangers  
Wrapped in Polythene  
Carpets Cleaned  
Eiderdowns Recovered

TELEPHONE STOURBRIDGE 3112 OR SEND POST CARD.



**FOR FURNITURE OF CHARM AND  
DISTINCTION**

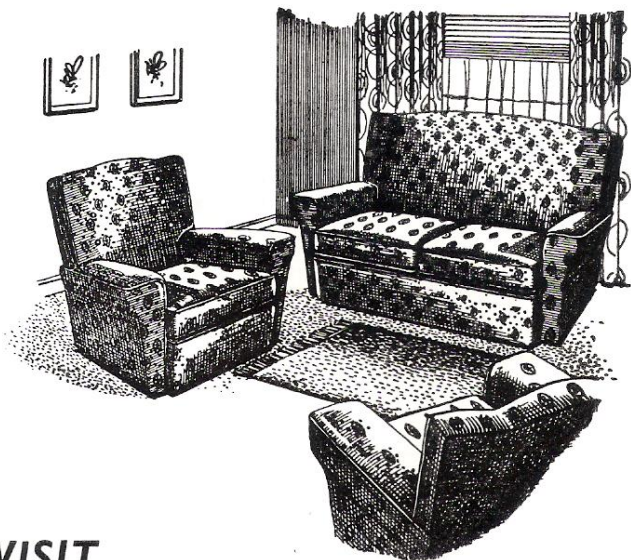

**VISIT**

**NOAKES**

**MODERN HOME FURNISHERS LTD.**

**MILL STREET AND PITTS LANE  
KIDDERMINSTER**

Phone 2972

**FOR SERVICE AND SATISFACTION**

THE TALK OF THE DISTRICT

HAVE YOU VISITED . . .

**MOYLE & ADAMS'**  
**NEW SHOP**

YET?

at

**86 WORCESTER ROAD**  
**WEST HAGLEY**

HIGH CLASS GROCERIES  
TOP QUALITY PROVISIONS  
GARDEN FRESH FRUIT & VEGETABLES  
EXCELLENT VARIETY FROZEN FOODS

— ALL AT REASONABLE PRICES —

ORDERS DELIVERED

ORDERS DELIVERED

# DARBY'S BAKERIES LTD.

Makers of the famous

## 'Mothers Pride' Bread

AMBLECOTE — STOURBRIDGE

# NEWBURY MOTORS LTD.

(G. T. Newbury, F.I.M.I.)

Appointed Retailers and Repairers

**ROLLS-ROYCE — BENTLEY**

DISTRIBUTORS

**JENSEN CARS**

Appointed Dealers

AUSTIN — MORRIS — WOLSELEY  
STANDARD — TRIUMPH — FORD

— o —

Highest Quality Used Cars Always in Stock  
Our Name is Your Guarantee

— o —

Specialised Service by Works Trained  
Supervisors and Staffs

— o —

Tel. HAL 1641

**MANOR LANE - HALESOWEN - nr. BIRMINGHAM**

# EDWARD RUTLAND & SON LTD.

Established 1854

•  
WINE AND SPIRIT MERCHANTS  
•

## Bordeaux House, Stourbridge

Telephones - - 4737 and 4738

CORSETRY — Berlei : Playtex : Sarong : Lovable : Felina : Silhouette, etc.  
LADIES' FASHIONS — Lingerie : Hosiery : Baby Linen : Children's Wear

## ANN'S

(Prop.: A. & B. BEAUMONT)

131 WORCESTER ROAD  
WEST HAGLEY

Telephone: HAGLEY 3096

DRAPERY AND HABERDASHERY  
CASH'S NAME TAPES  
SINGER SEWING MACHINE AGENT  
MAUDELLA PATTERNS

KNITTING WOOLS — Emu : Bairnsweat : Sirdar : Lee Target  
Paton & Baldwin's.

GENT'S WEAR — Vantella Shirts : Climax Shirts : Snowdrift Shirts  
Meridian and Aertex Underwear : Stability Hosiery.

— AGENT FOR " HUBCAR " PRAMS AND NURSERY EQUIPMENT —

*Enjoy Shopping and Save!*

AT

**Keith Thompson's  
SUPERMARKET**

**Hagley Road, Stourbridge**

**Opposite Library**

**CUT PRICES  
AND  
FREE GIFT STAMPS**

**FRIDAY NIGHT IS FAMILY NIGHT  
OPEN UNTIL 8 P.M.**

— **THE ONLY SUPERMARKET IN STOURBRIDGE** —

# Chapman's

**OF OLD HILL**

**YOUR ELECTRICAL STORE & SERVICE CENTRE**



INSTALLATIONS



SALES



SERVICE

Hagley Branch has closed. We are sorry to leave you; but — we look forward to seeing or hearing from you at our Head Office Old Hill. **Phone: Cradley Heath 66497.**

**114 REDDAL HILL ROAD, OLD HILL, STAFFS.**

## LEWIS W. WRIGHT

HIGH CLASS FAMILY BUTCHER

Pork Pies and Sausage a Speciality

**WORCESTER ROAD — HAGLEY**

Telephine Hagley 3026

### LET ME BE YOUR AUCTIONEER AND GET YOU BETTER BIDS . . . . .

Have you any articles or property that you want to sell? Better let me call attention to their values and get you good bids from a big crowd of lively buyers. I'm a County Express Classified, an old hand at this going, going gone business.

WHETHER BUYING OR SELLING USE THE  
**COUNTY EXPRESS CLASSIFIEDS**  
OVER 43,000 COPIES SOLD WEEKLY  
HEAD OFFICE: HIGH ST., STOURBRIDGE. Phone: 4721.

# HALESBRIDGE MOTORS

LIMITED

SINGER MAIN DEALERS AND DISTRIBUTORS  
ROOTES GROUP AGENTS



NOW available for immediate and early delivery

SINGER — VOGUE  
AND GAZELLE SALOONS  
VOGUE ESTATE CAR

Ask for a Demonstration in any of the Rootes Group Range . . .

HUMBER - HILLMAN - SUNBEAM  
SINGER - COMMER - KARRIER

Phone: STOURBRIDGE  
6161 - 2 - 3

or call at . . .  
NEW ROAD  
STOURBRIDGE

HALESBRIDGE MOTORS LTD.



Cover Design by Bill Nicholls